

NEW MODEL

REVISION

# Specification For Delivery



CUSTOMER

=

PART NUMBER

## XSC-1201000SEK

A0

<h3>Customer Approval</h3>			
担当者	审核	承认	公司承认章

SALES



P/N

XS-S

ENGINEER



RESPONSIBILITY



Tel: +82 707 019 3900 Fax: +82 2 2265 2650

[Http://www.icbanq.com](http://www.icbanq.com) E-mail: [Thomas@icbanq.com](mailto:Thomas@icbanq.com)

# Table of contents

SAFETY STANDARD.....	P3
INPUT CHARACTERIST.....	P3
OUTPUT CHARACTERIST.....	P4
PROTECTION FUNCTION.....	P5
ENVIRONMENTAL REQUIREMET.....	P5、 6
EMC STANDARDS.....	P7
MAJOR MEASURE EQUIPMENT.....	P7
PRODUCT OUTLINE .....	P8
RATING LABEL.....	P9
PACRING.....	P10

## UPDATE REV.

REV	UPDATE	DATE	PRERARATOR
original		2021.03.16	



Tel: +82 707 019 3900 Fax: +82 2 2265 2650

[Http://www.icbanq.com](http://www.icbanq.com) E-mail: [Thomas@icbanq.com](mailto:Thomas@icbanq.com)

## 1、SAFETY STANDARD:

1.1 The green mode power supply shall be certified by the following international regulatory standards:

<input type="checkbox"/>		Country	CertifiedStatus	Standard
<input type="checkbox"/>	PSE	Japan	APPROVED	J62368-1, J55032
<input checked="" type="checkbox"/>	UL	USA	APPROVED	UL 62368-1: 2014
<input type="checkbox"/>	cUL	CAN	APPROVED	UL 62368-1: 2014
<input type="checkbox"/>	FCC	USA	APPROVED	FCC Part15, Subpart B ANSI C63.4-2014
<input type="checkbox"/>	CE	Europe	APPROVED	EN62368 CE: EN 55032/EN55035/ EN61000/EN IEC61000 EN62368-1:2014
<input type="checkbox"/>	CE	Europe	APPROVED	EN60335-1 CE EN60335-1:2010 EN55014-1/2 EN61000/EN-IEC61000
<input type="checkbox"/>	GS	Europe	APPROVED	EN 60950-1/EN 61558-1/EN 61558-2-16/AfPGS 21
<input type="checkbox"/>	BS	UK	APPROVED	BS EN 60950-1/BS EN 61558-1/BS EN 61558-2-16
<input type="checkbox"/>	SAA	Australia	APPROVED	AS/NZS 60950-1:2011& AS/NZS 3112:2011
<input type="checkbox"/>	CCC	CN	APPROVED	GB4943-2001,GB1317625.1-2003
<input type="checkbox"/>	KC	KC	APPROVED	HU10898-16001C

## 2、INPUT CHARACTERIST:

### 2.1

INPUT VOLTAGE RANGE: **90Vac** to **264Vac**.

### 2.2

RATED INPUT VOLTAGE: **100Vac** to **240Vac**.

### 2.3

INPUT FREQUENCY RANGE: **47Hz** to **63Hz**.



Tel: +82 707 019 3900 Fax: +82 2 2265 2650

[Http://www.icbanq.com](http://www.icbanq.com) E-mail: [Thomas@icbanq.com](mailto:Thomas@icbanq.com)

### 3、 OUTPUT CHARACTERIST:

#### 3.1 Power output

RATED OUTPUT	Min. Load	Rated Output Load	Output power	No Load Power consumption
12 VDC	0 A	1 A	12W	0.1W

#### 3.2 Combined Load

RATED OUTPUT	Min. Load	Rated Output Load	Line Regulation	Load Regulation
12 VDC	0 A	1 A	±3%	±5% (11.4V-12.6V)

#### 3.3

Higher than 82.96 % at 100-240Vac input and output (25%, 50%, 75% & 100% load.)

#### 3.4 Ripple and Noise:

Under nominal voltage and nominal load,the ripple and noise are as follows when measure with Max.Bandwidth of 20MHz and Parallel 10uF/0.1uF,crossed connected at testing point.

Voltage	Ripple and Noise(Max.)
+12VDC	≤200mV p-p

#### 3.5 Turn on delay time:

3Second Max.at 115Vac input and output Max.load.

#### 3.6 Hold up time:

5 mS Min.at 115Vac input and output Max.Load.

#### 3.7 ELECTRIC WITHSTANDING STRENGTH(HI-POT)

Primary to Secondary AC3300V/10mA , 1 minute for type test. 3 second for production.

#### 3. Overshoot:

15% Max.When power supply at turn or turn off.



Tel: +82 707 019 3900 Fax: +82 2 2265 2650

[Http://www.icbanq.com](http://www.icbanq.com) E-mail: [Thomas@icbanq.com](mailto:Thomas@icbanq.com)

#### 4、 PROTECTION FEATURE:

##### 4.1 OVER - CURRENT PROTECTION:

The green mode power supply shall be hiccupped when any output operating in overload condition(set@ Max load 110~120% ) under any line condition for an indefinite period of time. The power supply shall be self - recovery when the fault condition is removed.

##### 4.2 SHORT CIRCUIT PROTECTION:

The power supply shall be hiccupped and no damage shall occur when any output operating in a short circuit condition under any line condition for an indefinite period of time. The power supply shall be self - recovery when the fault condition is removed.

#### 5、 ENVIRONMENTAL CONDITIONS:

##### 5.1 OPERATING:

The power supply shall be capable of operating continuously in any mode without performance deterioration in the following environmental conditions.

##### 5.1.1

Ambient Temperature: 0°C ~ 40°C

##### 5.1.2

Relative Humidity: 10% ~ 90%

##### 5.2 Vibration

Operating: IEC 721-3-3 3M3 5~9Hz,A=1.5mm

Acceleration (9~200Hz,Acceleration 5m/S<sup>2</sup>)



Tel: +82 707 019 3900 Fax: +82 2 2265 2650

[Http://www.icbanq.com](http://www.icbanq.com) E-mail: [Thomas@icbanq.com](mailto:Thomas@icbanq.com)

### 5.3 Cooling:

The power supply will operate with convection cooling .Blocking of vents must not cause damage to The power supply.

### 6、 Storage conditions:

The power supply shall be capable of withstanding the following environmental conditions extended periods of time, without sustaining electrical or mechanical damage and subsequent operational deficiencies:

#### 6.1.1

Ambient Temperature: - 30°C ~ 70°C

#### 6.1.2

Relative Humidity: 10% ~ 90%

#### 6.2.3 Vibration and Shock:

The power supply shall be designed to withstand normal transportation vibration per MIL-STD-810D, method 514 and procedures X, as it s mounted in the chassis assembly and packed for shipping.

### 7、 RELIABILITY AND QUALITY CONTROL:

#### 7.1 BURN-IN

The power supply shall undergo a minimum of 2 hours Burn-In test under full load at 40°C ~ ±5°C

#### 7.2 COMPONENT DERATING:

Semiconductor junction temperatures shall not exceed the manufacturer ' s maximum thermal rating.



Tel: +82 707 019 3900 Fax: +82 2 2265 2650

[Http://www.icbanq.com](http://www.icbanq.com) E-mail: [Thomas@icbanq.com](mailto:Thomas@icbanq.com)

## 8、 EMC STANDARDS:

### 8.1 EMI STANDARDS:

The power supply met the radiated and conducted emission requirements for FCC CLASS B,EN55022 CLASS B.

### 8.2 EMC STANDARDS:

The power supply shall meet the following EMC standards:

EN 55024: 1998+A1: 2001+A2: 2003; Part 15 Subpart B, IC ICES-003

## 9、 Energy Saving (Level VI / Level 6):

9.1 CEC Test Report (CEC Table U-2 Standards for Power Supplies Effective July 1, 2008)

9.2 EUP Test Report (COMMISSION REGULATION (EC) No 278/2009)

9.3 MEPS (AS/NZS 4665.2-2005)

## 10、 INSULATION RESISTANCE:

Input to output: 200M OHM(500VDC)

## 11、 LEAKAGE CURRENT:

The leakage current shall be less than 0.25mA for class II when power supply is operated maximum input voltage and maximum load.

## 12、 MAJOR MEASURE EQUIPMENT:

A. AC SOURCE: AFC - 500W

B. POWER METER: CHROMA 2100

C. ELECTRONIC LOAD: PRODIGIT 3310C

D. OSCILLOSCOPE: TDS-2012B

E. DIGITAL MULTIMETER: Fluke 4.5

F. DC POWER: WYK - 6030

G. HI - POT TESTER: LANKE ELECTRONICS 7112

H. INSULATION RASISTANCE TESTER: YD2681A



Tel: +82 707 019 3900 Fax: +82 2 2265 2650

[Http://www.icbanq.com](http://www.icbanq.com) E-mail: [Thomas@icbanq.com](mailto:Thomas@icbanq.com)

## PRODUCT OUTLINE DIMENSION

Unit :mm

Tolerance : ±0.5

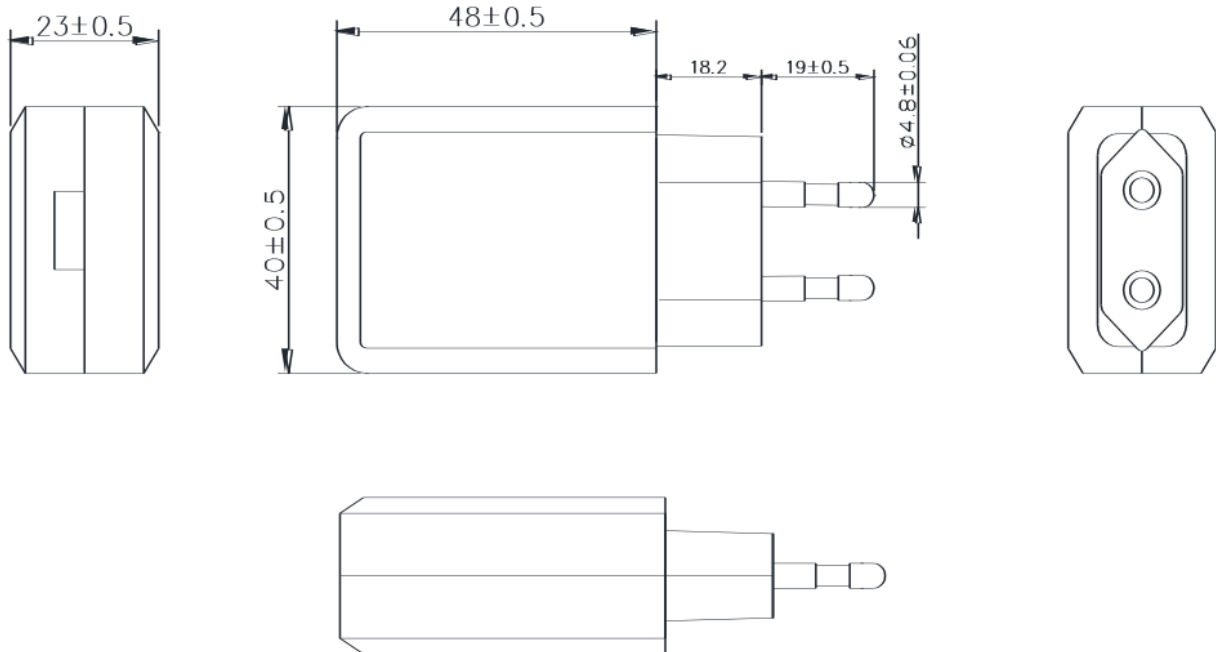

### 13、WEIGHT:

The weight of the power supply shall be about 80.5 g.

### 14、MECHANICAL REQUIREMENT:

The power supply size: L48\*W40\*H23mm

### 15、COLOUR:

Black     White



Tel: +82 707 019 3900 Fax: +82 2 2265 2650

[Http://www.icbanq.com](http://www.icbanq.com) E-mail: [Thomas@icbanq.com](mailto:Thomas@icbanq.com)



# DC CORD

Unit : mm

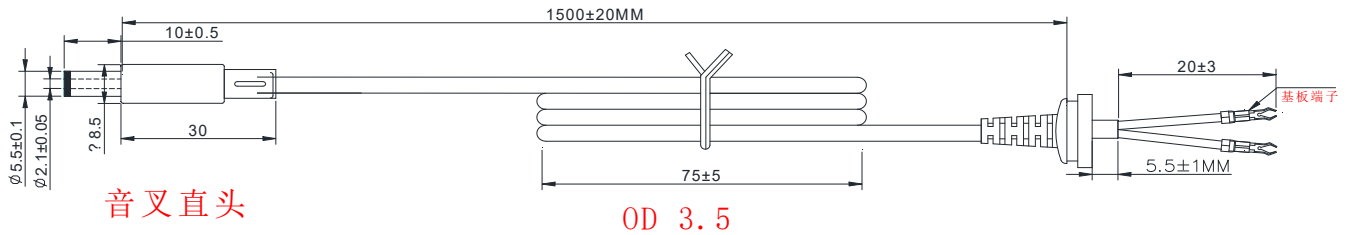

NOTE:

1. 线材:UL 2464 24AWG VW-1 80°C 300V
2. 颜色: 黑色
3. 极性: 黑色线 —●— 红色线
4. 拉力试验: 吊重20LBS, 60秒SR位移小于2mm;
5. 摇摆试验: 吊重500g, 每分钟35~40次, 120° 摇摆至少500次;
6. 线材硬度: DUROMETER TYPE A 70±10;
7. SR卡尾带基板端子

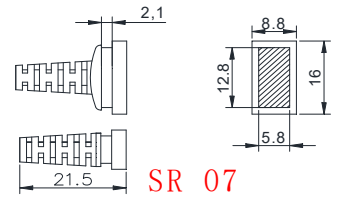

Tel: +82 707 019 3900 Fax: +82 2 2265 2650

[Http://www.icbanq.com](http://www.icbanq.com) E-mail: [Thomas@icbanq.com](mailto:Thomas@icbanq.com)

# RATING LABEL

Unit : mm

Tolerance :+0/-0.2mm

직류전원장치(SMPS)

모 델 명: XSC-1201000SEK

정격입력: 100-240VAC 50/60Hz 0.4A

정격출력: DC 12V 1000mA

제 조 원: Shenzhen Sunshine Technological Co.,Ltd.



제조년월:    년    월



HU101011-20002B

R-R-XSC-XSC-1201250SEK

A/S연락처:XXXXX



Made In China



Tel: +82 707 019 3900 Fax: +82 2 2265 2650

[Http://www.icbanq.com](http://www.icbanq.com) E-mail: [Thomas@icbanq.com](mailto:Thomas@icbanq.com)

# RATING LABEL

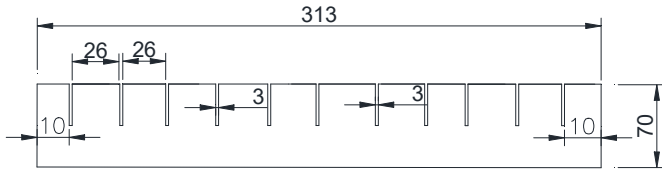

11刀卡

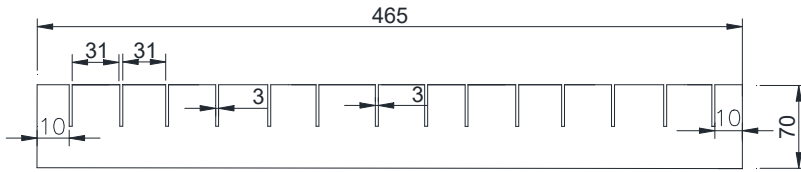

14刀卡

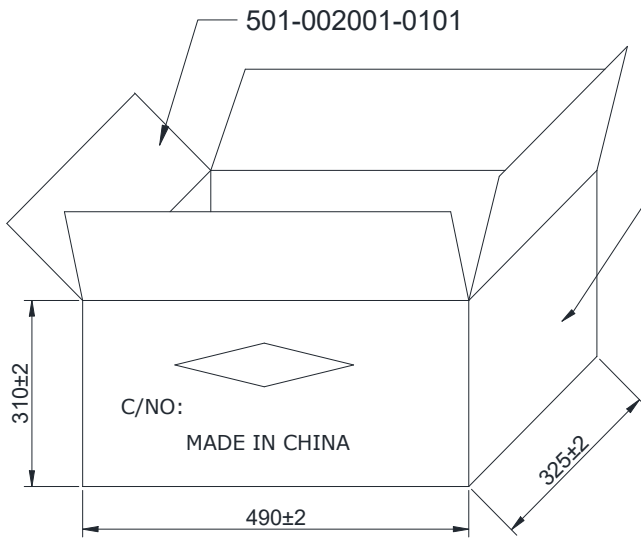

P.O:  
P/N:  
QTY: PCS  
N.W.: KGS  
G.W.: KGS

**NOTE:**

1. PE袋刀卡包装，每箱包装160台。
2. PK箱标示尺寸为外部尺寸
3. PK箱印前後相同，左右相同，印刷颜色为黑色



Tel: +82 707 019 3900 Fax: +82 2 2265 2650

[Http://www.icbanq.com](http://www.icbanq.com) E-mail: [Thomas@icbanq.com](mailto:Thomas@icbanq.com)